

Picture B: Before installation, firstly, to open a hole $\Phi 110\text{mm}$ (4-3/8") of the panel, make sure there is a space with(55mm backyard of panel) as well.

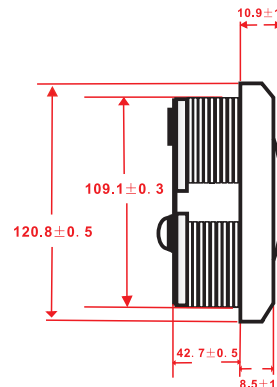

Picture E: Size and annotations

Picture D: Put the gauge in the hole and screw down.

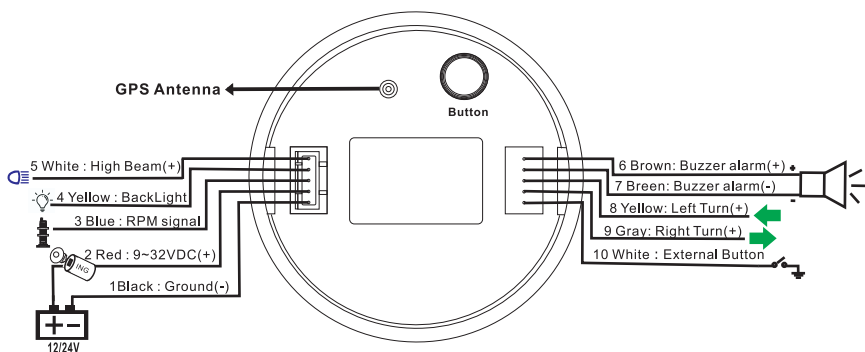

F Wiring diagram

Connection

- 1 Black : Ground(-)
- 2 Red : 9~32VDC(+)
- 3 Blue : RPM signal
- 4 Yellow : BackLight
- 5 White : High Beam
- 6 Brown: Buzzer alarm(+)
- 7 Green: Buzzer alarm(-)
- 8 Yellow: Left Turn
- 9 Gray: Right Turn
- 10 White : External Button

Outboard	
Poles	Speed Ratio
4	2
6	3
8	4
10	5
12	6

Diesel Engine	
Gear Number	Speed Ratio
Speed Ratio = Gear Number	

GPS installation instructions

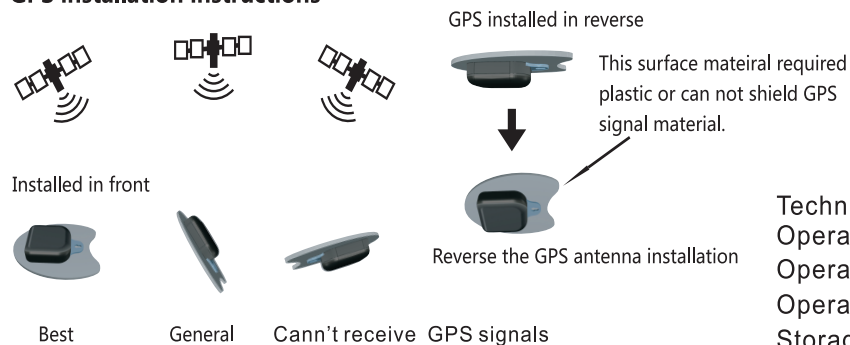

Technical parameters:
 Operating voltage: 9~32VDC
 Operating current: $\leq 100\text{mA}$
 Operating temperature: $-30\sim 80^{\circ}\text{C}$
 Storage temperature: $-40\sim 85^{\circ}\text{C}$

Inboard Gas Engine		
Cylinder	Cycle	Speed Ratio
4	4	2
6	4	3
8	4	4
10	4	5
12	4	6

1. Press and hold the rubber button on the back of the meter for 3 seconds to enter the setting mode. If you release the button for more than 3 seconds, it will exit the setting mode.
2. Press and hold the button, the value keeps increasing; release the button and press the button again, the value keeps decreasing. The longer the button is held down, the faster the value counts. The minimum step value of counting is 0.1, and the adjustable range is 1.0-360.
3. After adjusting the speed ratio to meet your requirements, please release the button. After 3 seconds, the tachometer will automatically save the result you set. If the settings do not meet your requirements, please reset them.
4. Overspeed alarm: After power on, short press the button on the back of the instrument twice to enter the overspeed alarm adjustment mode, and then press and hold the button on the back to display the overspeed alarm adjustment. Press and hold the button repeatedly, and the value will continue to increase. It is automatically saved after 5 seconds. If the settings do not meet your requirements, please reset them.
5. The default stroke is a single accumulative, and it will not be cleared when the power is off. Long press the button to clear it.
6. Turn on the instrument, the star searches for the signal, and the LCD displays "gps--". If there is still no GPS signal after 3 minutes, the LCD displays "Err".